

Notes:

Overlapping the fibreglass mesh in the basecoat reinforcement layer. Typical mesh cloth width is 1000mm.

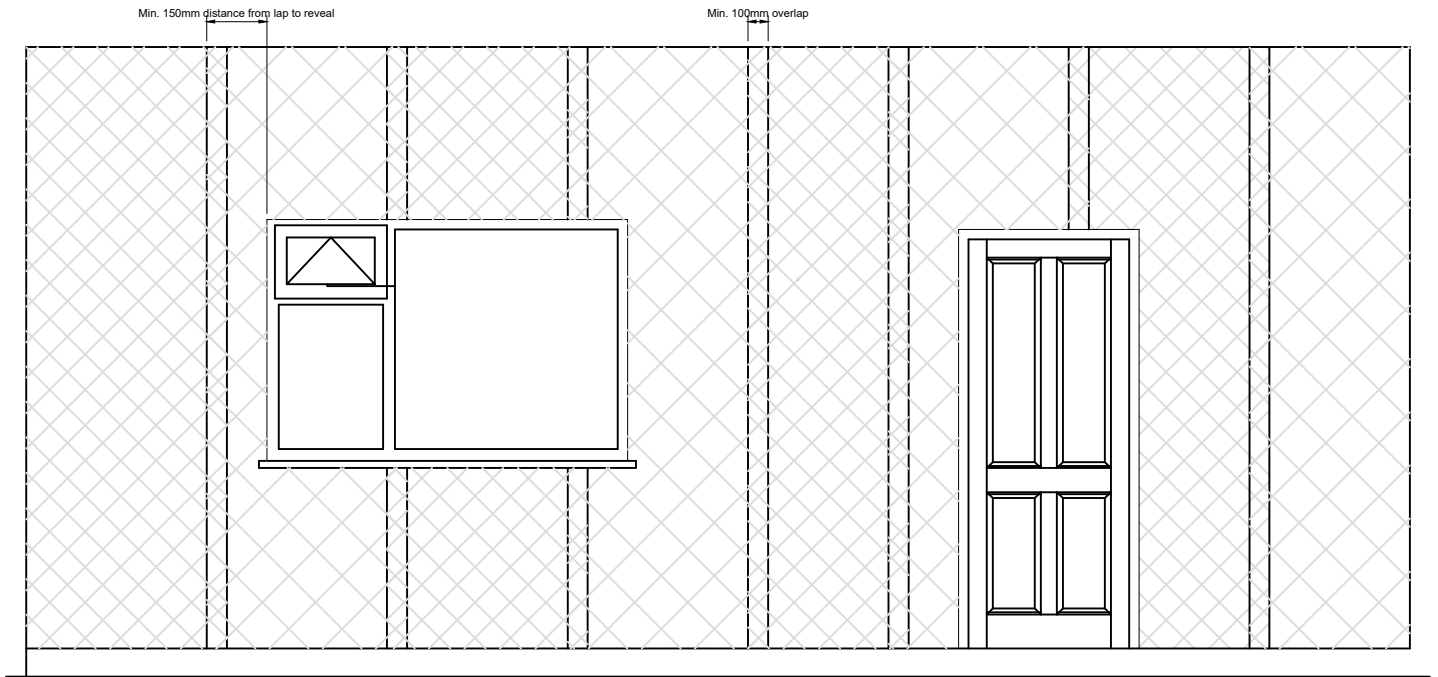

DRAWING TITLE: Typical Mesh overlapping detail

DRAWING No: EP - 047

DATE: 01-05-2014

SCALE: NTS

\*For fixing patterns, please refer to relevant diagrams.



EWI Pro Insulation Systems LTD.  
Kingston Bussines Centre Unit1  
Fullers Way South  
Chessington KT9 1DQ