

Building Systems Project Specification

Project name:

System Description EPS bonded & mechanically fixed to mixed masonry with a thin-coat render finish

System name M21_NB_BW_EPS_TC_075

Specification Type: Standard

Site Specific Information:

Finishes in scope: EWI-075 1.5mm Silicone Render

EWI PRO PROJECT SPECIFICATION

EWI Pro Project Specification has been designed to outline the specific requirements for completing a project efficiently using EWI Pro systems. Project specifications are necessary for describing the materials, skills and labour required for project development. This document details all the requirements for completing an EWI Pro project, from the pre-treatment of substrates to installation. Failure to adhere to EWI Pro Project Specification may result in unnecessary delays.

SAMPLE

100 SYSTEM BACKGROUND

The system comprises a thin-coat render system applied to mixed masonry construction.

New Blockwork Render Only

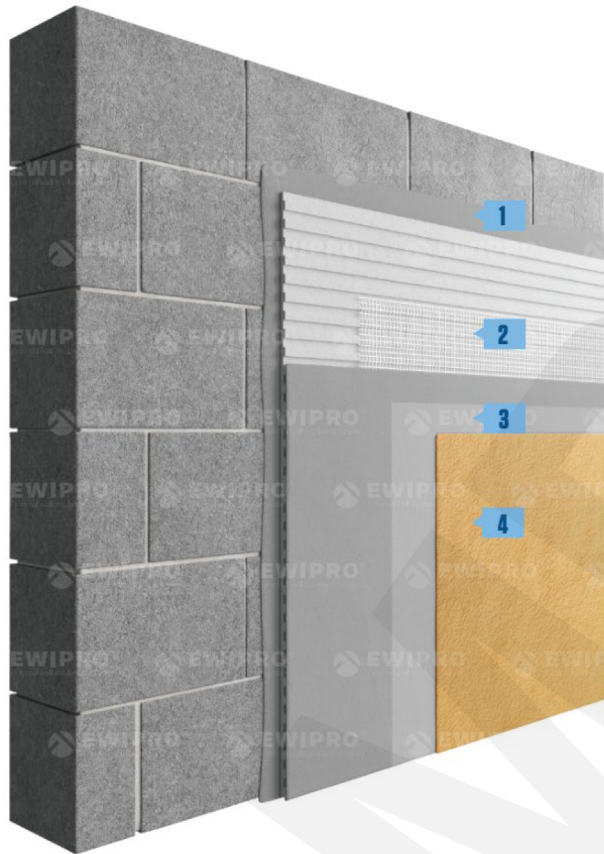

- 1** Optional Surface Preparation
(Levelling Coat or Primer)
- 2** Reinforcement Layer (Basecoat & Mesh)
- 3** Render Primer (Optional)
- 4** Decorative Finish

Technical update (07.01.2019): We require all Design & Build Contractors, Project Improvers, Architects and so forth to check with their third-party warranty provider on the suitability of this specification to meet their insurance obligations. EWI Pro Insulation Systems Ltd. cannot be held accountable if this permission is not sought before the installation of this system, and an issue of a product or system suitability arises in the commissioning of the system further down the line.

Technical update (31.01.2019): Following a revision to the Fire Safety Regulations (Document B), we seek all Project Improvers to validate this project design with Local Building Control or with their Insurance Providers. The current Fire Safety Regulations are enforceable, particularly if the build is less than 1000mm (1 metre) from the boundary wall.

CONTENTS

100 System background.....	2
EWI Pro Project Specification.....	3
System components.....	6
Beading.....	6
110 Reviewing system drawings.....	6
120 Surveying the existing walls/substrate.....	7
160 Remedial work.....	7
210 External Wall Render System.....	7
Pre-treatment of the substrate.....	8
Parge coat layer (optional).....	8
Basecoat 'reinforcement' layer.....	8
Render primer.....	9
Decorative render finish.....	9
300 System design.....	9
320 Integrity.....	10
330 Impact loading.....	10
350 Wind loading.....	10
351 Additional loading.....	10
360 Samples.....	10
370 Uniformity of colour and texture.....	11
Installation.....	11
410 Approved installers.....	11
415A Installation application.....	11
420 Weathering conditions.....	12

Please contact us for further details on specifications